

Building Occupant Survey

A grant from the American Society of Heating, Refrigeration, and Air-Conditioning Engineers (ASHRAE) has presented a group of student a unique opportunity to perform research and analysis of two existing “green” buildings.

We are asking for your help to determine the specific parameters to monitor in our investigation. We will then use equipment purchased through the ASHRAE grant and a previous State of Michigan Vital Signs grant to monitor the HVAC, lighting, and indoor air quality of the two structures. Simultaneously, we will gather the buildings’ information and generate simulations using whole-building energy simulation software.

At the end of the investigation, we will generate a report making recommendations for improving the operation of both of these sustainable buildings based on their simulations and monitoring in a formal report.

Please take a few moments to help in our efforts to improve the built environment and gain valuable information in the design and operation of high-performance buildings by completing this survey. Your answers will establish parameters for our research, and could ultimately improve the space you occupy.

Thank you for your support and help!

Sincerely,
The High Performance Building Team

High Performance Building Investigation

Taubman Student Services Building Survey.

Help us improve your space! Please save and email this file to survey@grabows.us or send via interdepartmental mail to Janice Means in Architecture.

1. What is your age? *17 or less* *18-30* *31-40* *41-50* *51-65* *over 65*

2. What is your gender? *female* *male*

3. How many hours a week do you spend in the building?
 Less than 10 *10-20* *20-30* *30-40* *more than 40*

4. How many hours a week do you spend in one location in the building?
 Less than 10 *10-20* *20-30* *30-40* *more than 40*

5. How do you occupy the space? Check all that apply.
 employee *student* *visitor*

6. Mark any times below that you are uncomfortable in the building.

	<i>Summer</i>	<i>Fall</i>	<i>Winter</i>	<i>Spring</i>
<i>Morning</i>				
<i>Mid-day</i>				
<i>Afternoon</i>				
<i>Evening</i>				

7. Is the thermostat for your HVAC zone located conveniently to your workstation? *Yes* *No* *N/A*

8. Do you experience any uncomfortable drafts? *Yes* *No* *N/A*

9. Does noise from the HVAC system interfere with your concentration? *Yes* *No* *N/A*

10. Do you experience comfort problems from natural sunlight? *Yes* *No* *N/A*

11. Is the lighting in your work area bright enough to meet your needs?
 strongly agree *agree* *neutral* *disagree* *strongly disagree*

12. How satisfied are you with the lighting equipment in your work area?
 very satisfied *satisfied* *neutral* *unsatisfied* *very unsatisfied*

13. The daylighting in your work area is...
 Acceptable *Not enough daylighting* *Too much daylighting/ too bright/glare*

14. The air in your building is generally odor free? *Yes* *No* *N/A*

15. Do you find yourself coughing and or sneezing more when in the building? *Yes* *No* *N/A*

16. Do you have access to natural ventilation (operation windows or doors)? *Yes* *No* *N/A*

17. If you have access to operable windows are you satisfied with the availability of the outdoor air?
 Yes *No* *N/A*

18. If you have a preexisting health problem is it worsened in the building? *Yes* *No* *N/A*

19. Do you notice any skin irritation while in the building? *Yes* *No* *N/A*

20. Are you satisfied with the taste/smell of the water in your building? *Yes* *No* *N/A*

21. Is the water pressure in your building adequate? *Yes* *No* *N/A*

22. Is the water temperature in your building adequate? *Yes* *No* *N/A*

23. Do the automatic fixtures work properly? *Yes* *No* *N/A*

24. Do the plumbing systems perform all required tasks quietly and efficiently? *Yes* *No* *N/A*

25. What is your level of physical activity while in the building?
 low *medium* *high*

Please click the locations that you spend time in the boxes on the floor plans below.

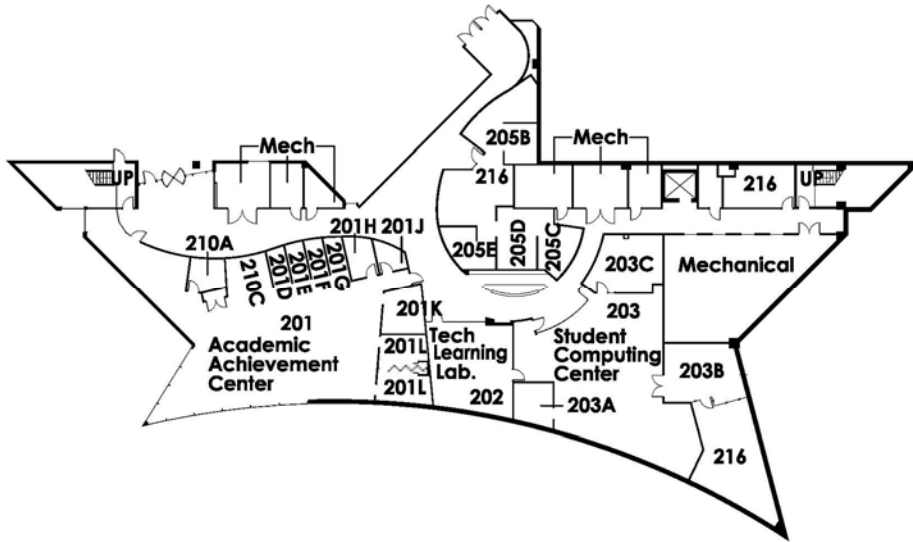

A. Alfred Taubman Student Services Center (Unit C)

Second Floor

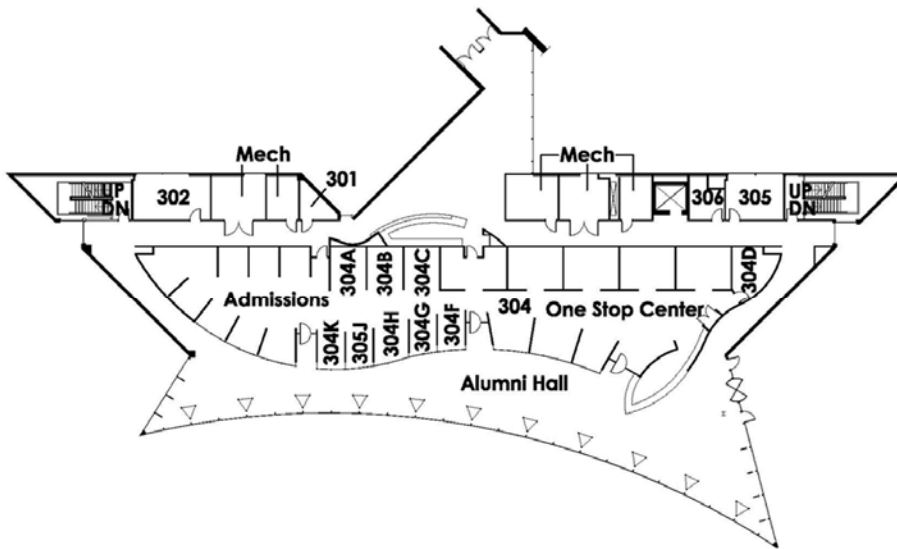

A. Alfred Taubman Student Services Center (Unit C)

Third Floor

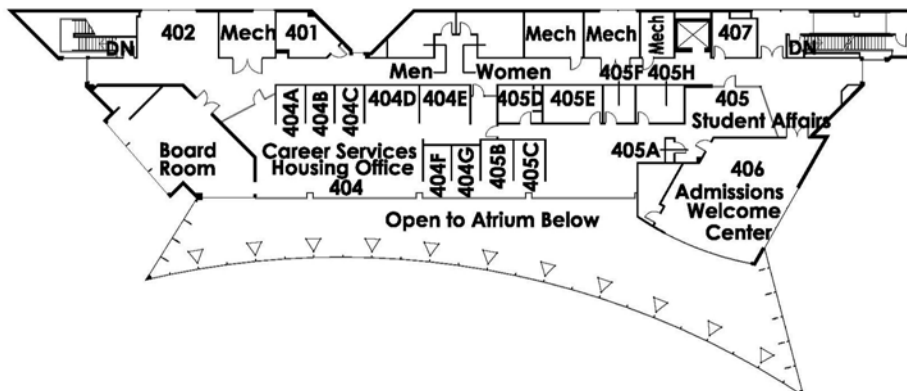

A. Alfred Taubman Student Services Center (Unit C)

Fourth Floor

Please use the space below to provide any additional comments or suggestions. If you would like someone to contact you, please provide contact information in the box below.

Thank you for your assistance.
